

Nomadic  **Display**®

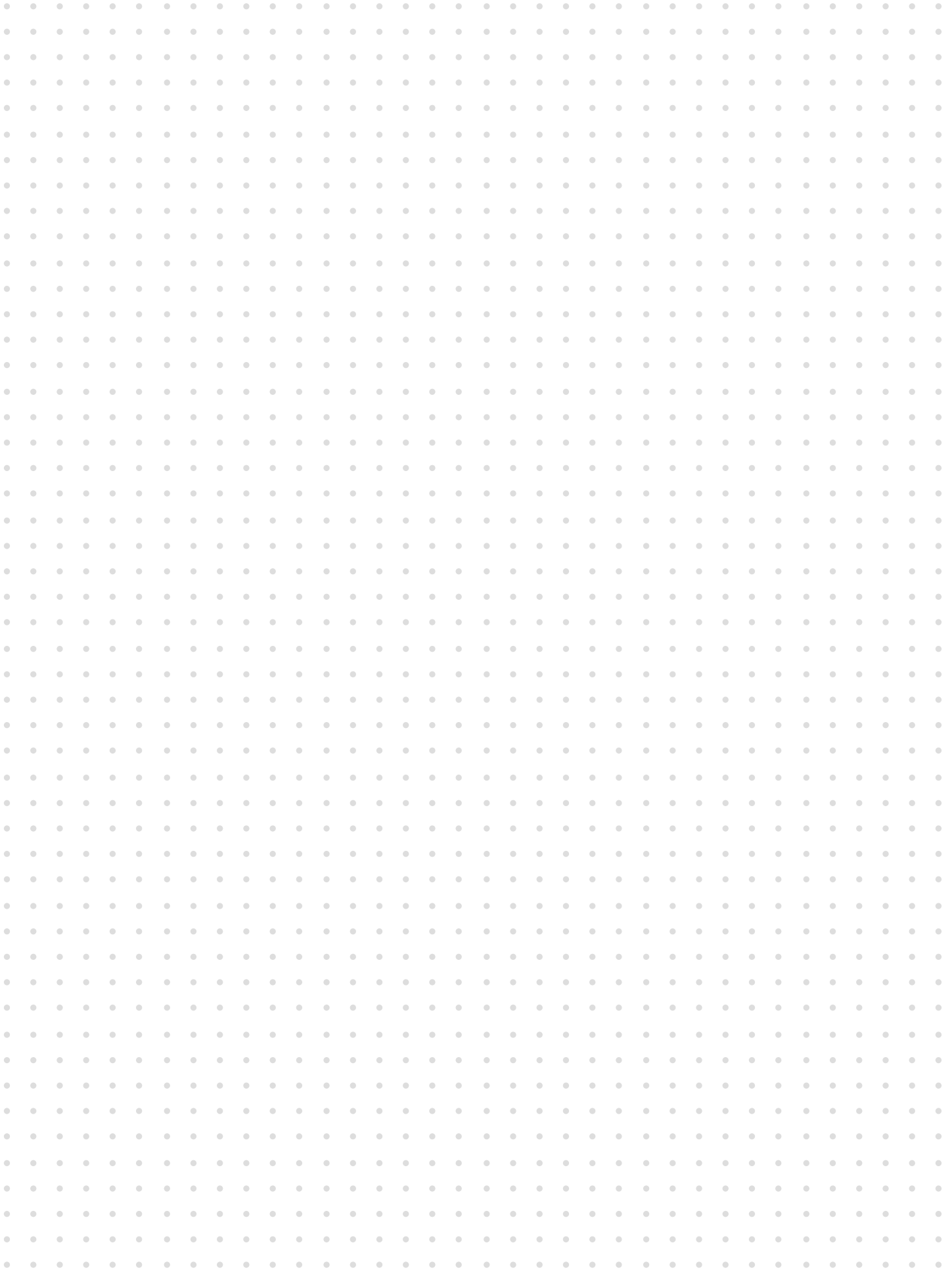

**EXHIBITION COUNTERS
PRODUCT CATALOGUE**

NOTES





WHY CHOOSE **NOMADIC DISPLAY** AS YOUR EXHIBITION PARTNER ?

With a rich history and unmatched expertise, Nomadic Display remains the go-to choice for businesses worldwide.



PIONEERING LEGACY

Nomadic Display pioneered the exhibition industry over 40 years ago with Ted Zeigler's invention of the "Pop Up Stand." When you partner with us, you're tapping into decades of groundbreaking design and unparalleled expertise.



UNMATCHED PRODUCT DIVERSITY

From Modular Stands to LED Backlit Displays, we offer a diverse range of products tailored to every need. Our dedication to innovation ensures that we consistently go beyond client expectations.



COMMITMENT TO CLIENT SUCCESS

At Nomadic Display, we don't just focus on transactions; we emphasize building genuine partnerships with our clients. By ensuring mutual success, we take pride in our dedicated team that offers exceptional post-purchase support to every customer.



40+

Years of Experience in the Exhibition Industry



100+

Award Winning Projects



20,000+

Satisfied Clients

OUR CORE VALUES



Partnerships



Sustainability



Quality



Professionalism



Innovation



Integrity

At the core of everything we do lies professionalism, integrity, innovation, and sustainability. Our mission is to forge lasting strategic partnerships with our customers. We are committed to setting the benchmark in the exhibition and display industries, delivering high-quality products with a guarantee of 100% satisfaction.

ABOUT US

 Made in Europe

Our team at Nomadic Display has been working for over 40 years to help you get the most out of your time spent at trade shows, exhibitions, and other sales events. The exhibition stands we create are some of the most innovative and economical in the industry, and they provide real returns for our clients, both now and in the future.

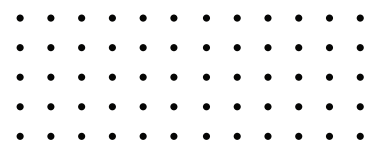

GREEN COMMITMENT

A DEVOTION TO ENVIRONMENTAL LEADERSHIP IN THE EXHIBITION INDUSTRY

Since our inception, Nomadic Display has championed sustainability. We're an eco-conscious company, always innovating to optimize our energy and resource use. Our commitment runs deep, evidenced by our efforts to curtail our carbon footprint, reduce waste, and conserve water.



SEAMLESS ADAPTABILITY

Our products are masterfully designed to cater to multiple events, not only minimizing waste but also maximizing your investment. Each product's versatility ensures adaptability across your exhibition calendar.

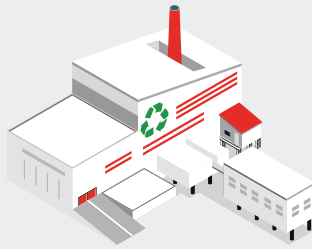

EARTH-CONSCIOUS CRAFTING

At the foundation of our production is high-quality, recycled materials. Our eco-friendly manufacturing goes beyond mere processes; it's our commitment to the planet. Even in the rare instances of wastage, we prioritize recycling and repurposing.



TIMELESS DURABILITY

We don't just create products; we build legacies. Our items are designed for longevity and to withstand repeated use. Every piece we create is backed by our unwavering warranties, a testament to our faith in their durability.

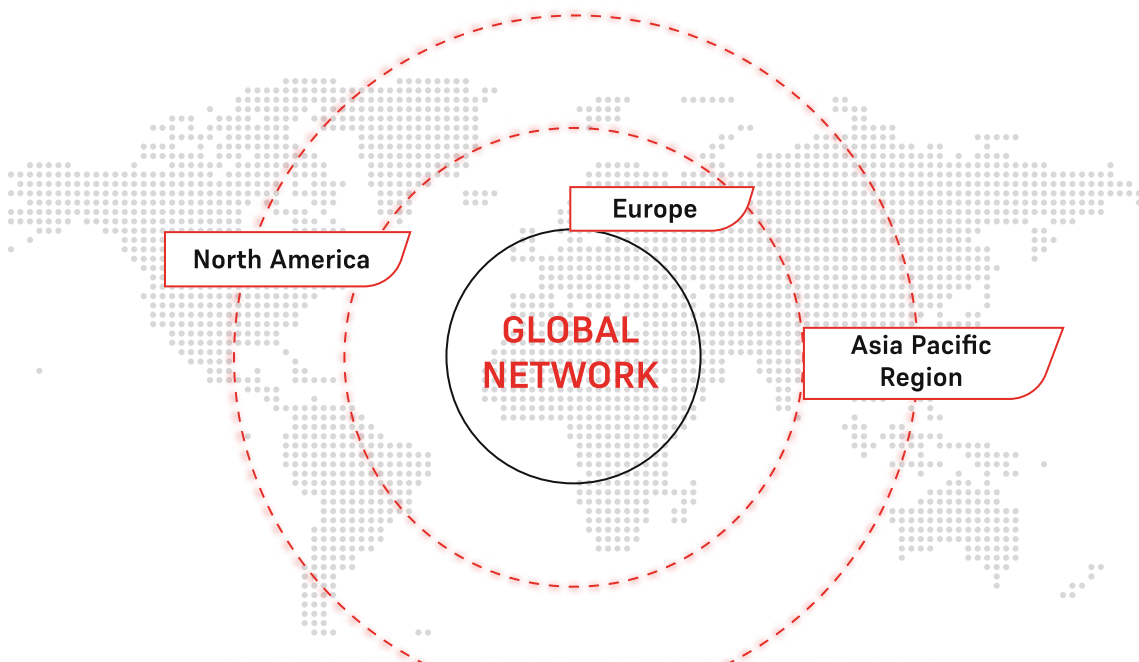

We are available all around the world through our extensive distribution network

EXHIBITION SERVICES

YOUR ONE-STOP SOLUTION FOR SEAMLESS EXHIBITIONS

At Nomadic Display, we understand the intricacies of the exhibition world. That's why we offer a comprehensive range of services designed to make your exhibition journey smooth and hassle-free.

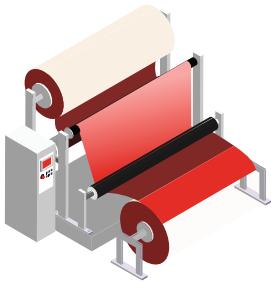

IN-HOUSE PRINTING

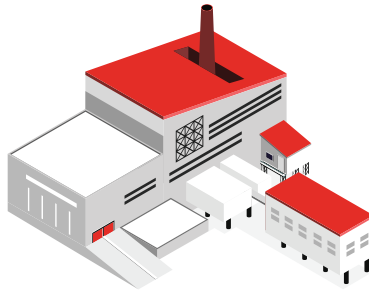

EXHIBITION STAND MANUFACTURING



GLOBAL EXHIBITION STAND INSTALLATION



EXHIBITION STAND RENTAL

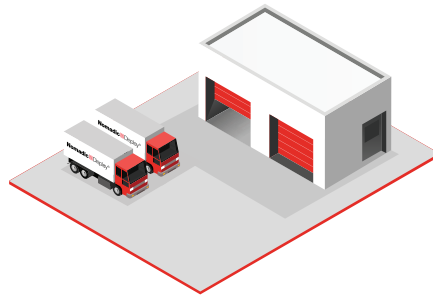

EXHIBITION STORAGE



24/7 SUPPORT



EXHIBITION STAND DESIGN

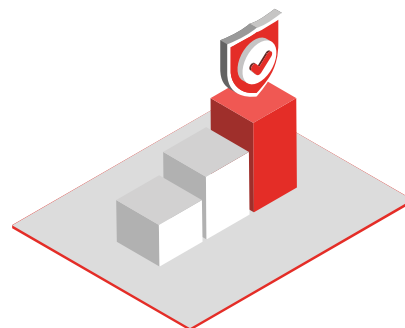

INDUSTRY LEADING WARRANTIES

At Nomadic Display, we pride ourselves on offering a comprehensive suite of exhibition solutions tailored to meet the diverse needs of businesses worldwide. Our commitment to innovation, quality, and versatility shines through in every product we craft.

OUR PREMIER PRODUCT CATEGORIES

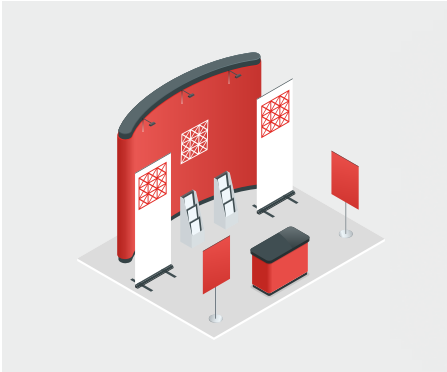

MODULAR EXHIBITION STANDS

Crafted for flexibility and impact, our modular stands can be tailored to fit any exhibition space, ensuring your brand remains the focal point.

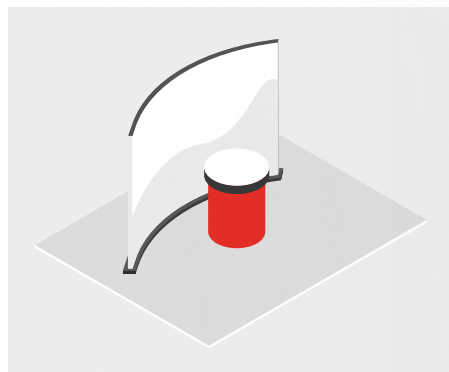

POP-UP STANDS

As the pioneers of the Pop Up Stand, we offer lightweight and portable options that are perfect for exhibitors on the go, ensuring a grand impression in any setting.

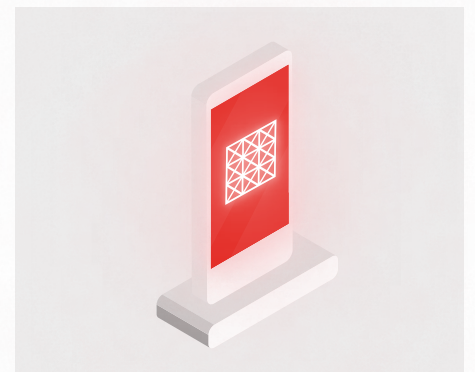

LED BACKLIT DISPLAYS

Illuminate your brand message with our state-of-the-art LED backlit displays. Designed to captivate and engage, these displays are a beacon of innovation.

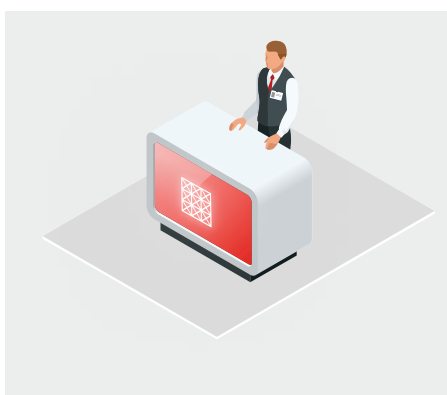

LED BACKLIT COUNTERS

Combine functionality with aesthetics. Our LED backlit counters not only serve as an interactive space but also enhance the ambiance of your exhibition area.

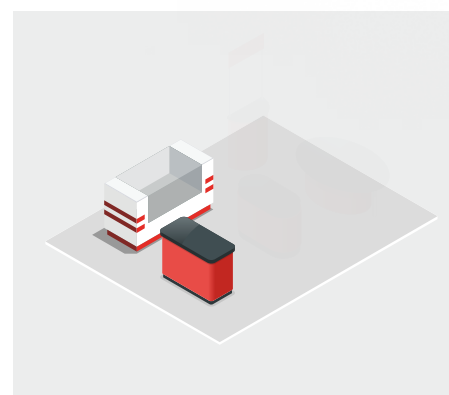

EXHIBITION COUNTERS

From product showcases to interactive hubs, our range of exhibition counters are designed to be both practical and visually appealing.



EXHIBITION ACCESSORIES

Complete your exhibition setup with our curated range of accessories. From lighting solutions to graphic panels, we've got everything you need to enhance your display.

OUR CLIENTELE

Over the years, we have established ourselves as a trusted name in the exhibition industry. Our journey began with a simple vision: to provide unparalleled products and services that would help businesses showcase their brands in the best light possible. Today, we are proud to say that we have turned that vision into a reality.

JOIN **20,000+** SATISFIED CLIENTS
GLOBALLY IN TRUSTING **NOMADIC
DISPLAY**

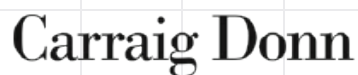

OUR EXHIBITION SOLUTIONS ARE CERTIFIED FOR EXCELLENCE

At Nomadic Display, our exhibition solutions are certified under three categories, upholding industry standards for quality, safety, and performance. Rest assured, our products are crafted to provide you with the best possible display experience.

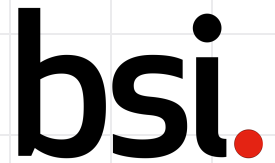

FEATURES



MODTRCURONE

+



MODTRCUREXTRA1

=



Max Load Weight per counter  100KG



MODTRREONE

+



MODTRRECEXTRA1

=



Max Load Weight per counter  100KG



MODTRCURONE

+



MODTRRECEXTRA1

+



MODTRCUREXTRA1

=



POSSIBLE CONFIGURATIONS

Set-up
3 - 5min



MODCTRCURONE

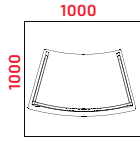

+



=



1 X MODCTRCUREXTRA1



MODCTREONE

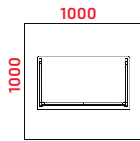

+



=

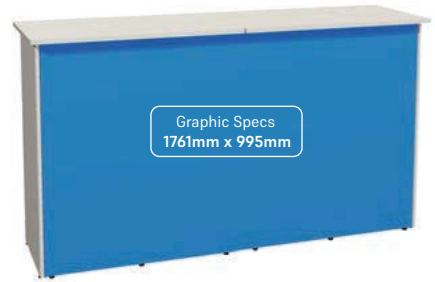

1 X MODCTRECEXTRA1

1 X MODCTRCURONE
1 X MODCTRCUREXTRA1

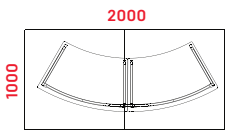

+



=



1 X MODCTRECEXTRA1

1 X MODCTRCURONE
1 X MODCTRECEXTRA1
1 X MODCTRCUREXTRA1

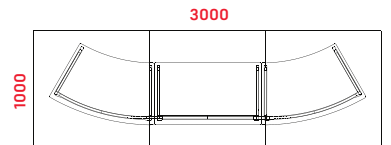

1 X MODCTREONE
1 X MODCTRECEXTRA1

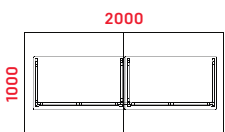

+



=



2 X MODCTRCUREXTRA1

1 X MODCTREONE
1 X MODCTRCUREXTRA1
1 X MODCTRECEXTRA1

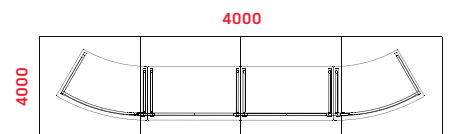

POSSIBLE CONFIGURATIONS

Set-up
5 - 7min



- 1 X MODCTRCURONE
- 3 X MODCTRCUREXTRA1

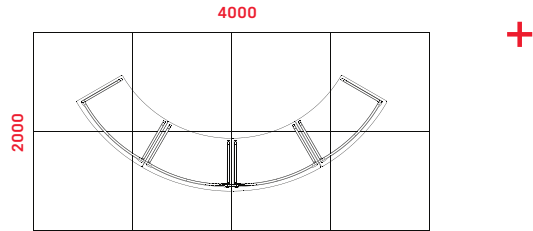

=



- 1 X MODCTRCURONE
- 5 X MODCTRCUREXTRA1

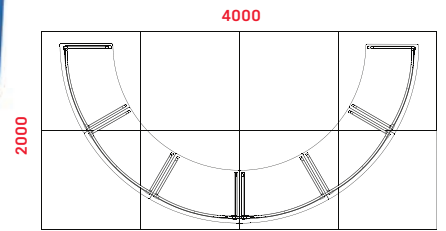

- 2 X MODCTRCUREXTRA1



- 1 X MODCTRECONE
- 1 X MODCTRECEXTRA1
- 3 X MODCTRCUREXTRA1

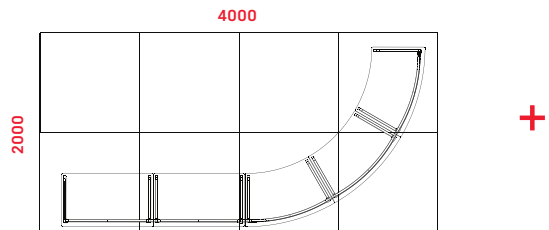

=



- 3 X MODCTRCUREXTRA1

- 1 X MODCTRECONE
- 6 X MODCTRCUREXTRA1
- 1 X MODCTRECEXTRA1

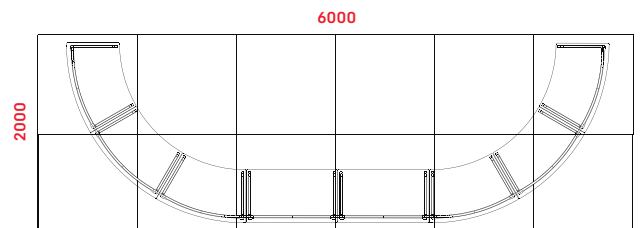

ACCESSORIES



1 Door Kit for Curved Module
MODCTRDOORCUR

2 Door Kit for Rectangular Module
MODCTRDOORCUR

3 Grommet
HXXGROM0000000

BENEFITS

Quick Assembly

Modular

Lifetime Warranty

35KG per case
1 Counter per case

Low Cost

Lightweight

Tool-less Assembly

ORDER CODES



Single Curved Module

MODCTRCURONE



Components of
Extra Curved Module

MODCTRCUREXTRA1



Door kit for
Curved Module

MODCTRDOORCUR

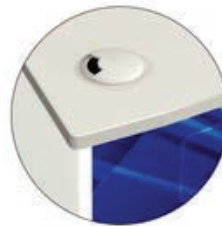

Grommet

HXGROM00000000



Single Rectangular
Module

MODCTRREONE



Components of Extra
Rectangular Module

MODCTRREEXTRA1



Door Kit for
Rectangular Module

MODCTRDOORREC

SET-UP INSTRUCTIONS



CURVED EVOLVE COUNTER SETUP INSTRUCTIONS

1

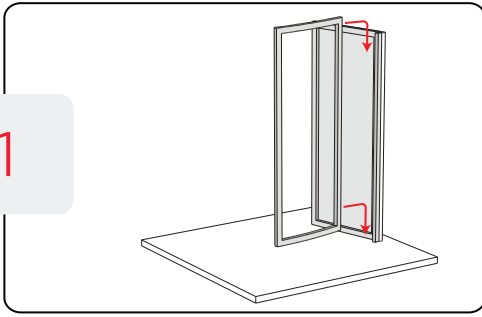

2

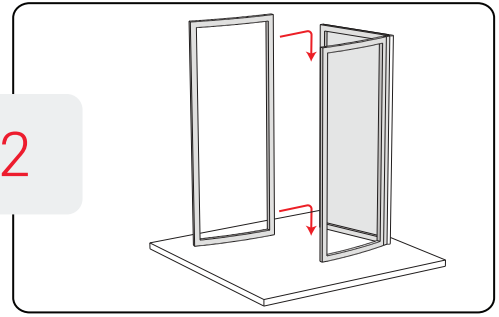

3

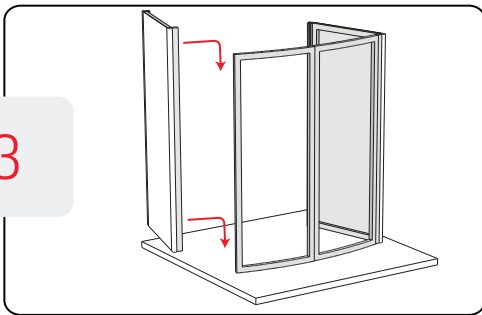

4

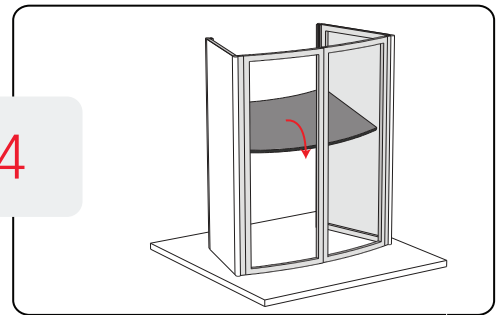

5

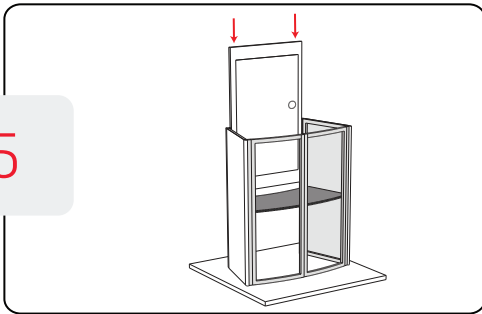

6

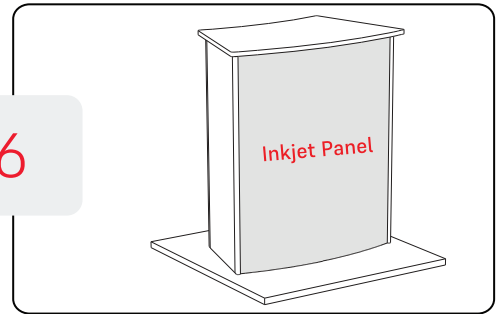

GENERAL ASSEMBLY

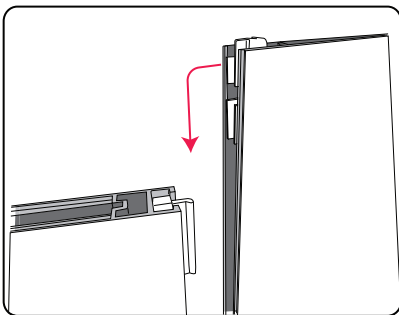

Align the panels and slide the female connectors down over the male connectors.

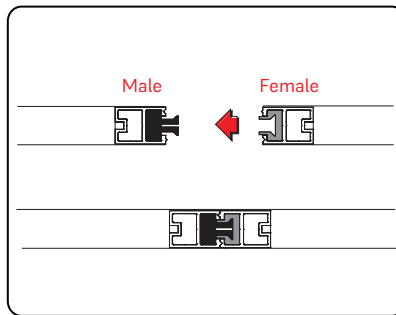

All panels have male and female connectors. The male connector should always be on your right when facing the front of the display.

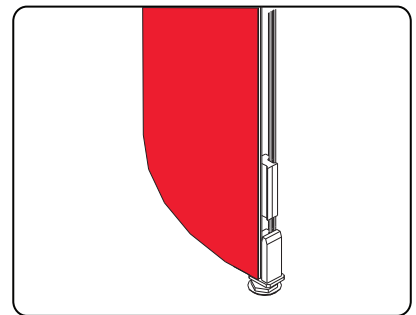

The base level has adjustable feet that allow you to level the display on an uneven floor. You should assemble the entire base level before adjusting feet.

RECTANGLE EVOLVE COUNTER SETUP INSTRUCTIONS

1

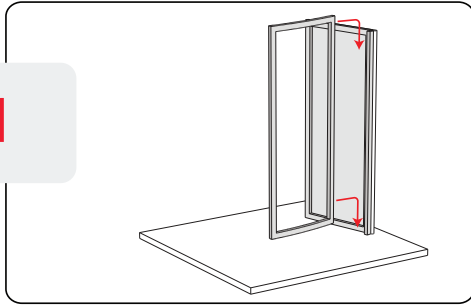

2

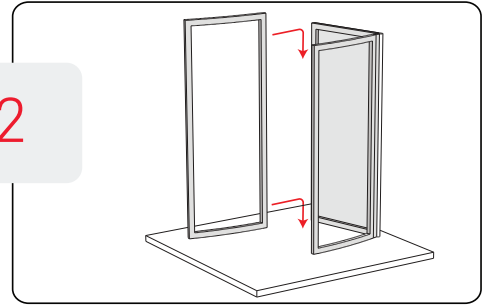

3

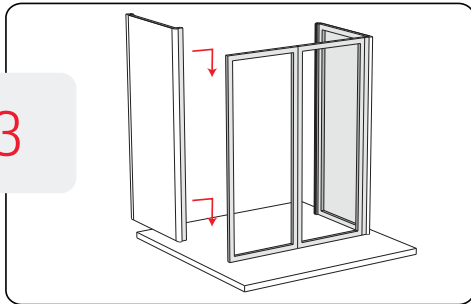

4

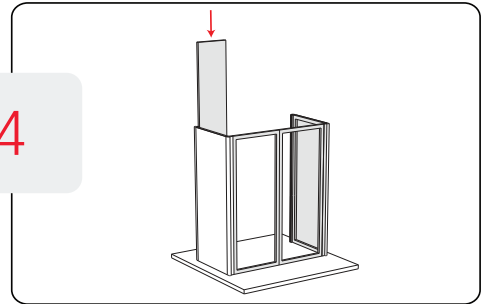

5

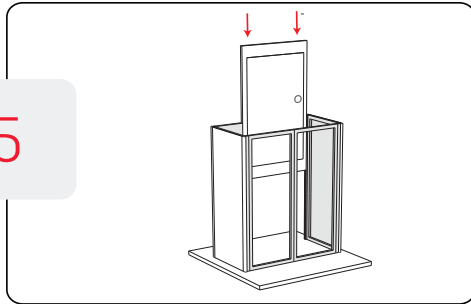

6

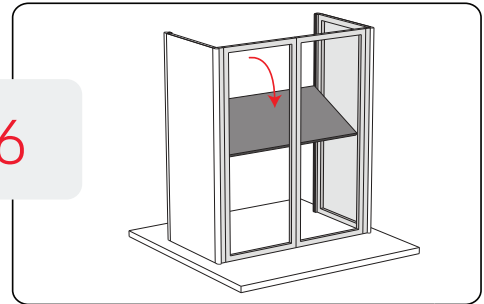

7

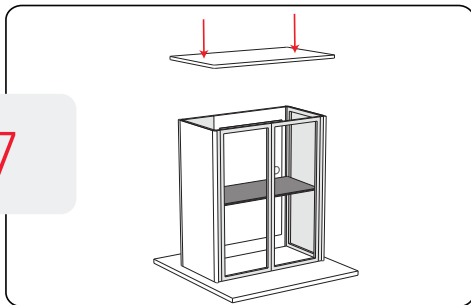

8

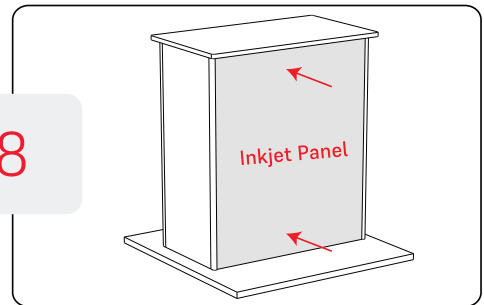

GENERAL ASSEMBLY

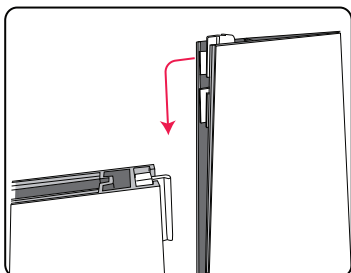

Align the panels and slide the female connectors down over the male connectors.

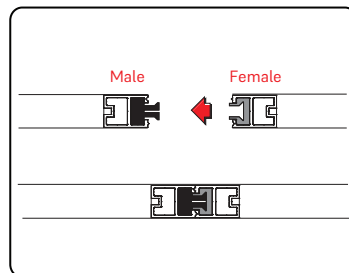

All panels have male and female connectors. The male connector should always be on your right when facing the front of the display.

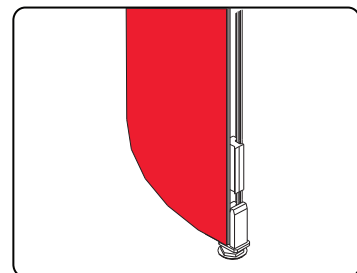

The base level has adjustable feet that allow you to level the display on an uneven floor. You should assemble the entire base level before adjusting feet.

BRIGHTWALL - COUNTERS

MODERN - SOPHISTICATED - BRIGHT

BrightWall 130 counters are the perfect accessory for your event! Available in three different formats they cover all your needs. All our counters feature a 1m x 1m aluminium frame with built-in lights to maximise your branding space and offer single or double sided options.



BRIGHTWALL 130 - COUNTER 1

A SIMPLE, PORTABLE AND HIGH IMPACT COUNTER

Available in single sided or double sided, this counter is perfect for those who want a counter to take on the road with them. This counter features a fully backlit 1m x 1m display with two stability feet and a high-quality white laminate countertop.

CODE	WSLKCO006
ASSEMBLED SIZE	1036 X 1028 X 320mm
VISUAL AREA	1000 X 1000mm
NUMBER OF BAGS	1
PACKED DIMENSIONS	350 x 220x 1310mm
PACKED WEIGHT	19kg
POWER	102W



BRIGHTWALL 130 - COUNTER 2

A HIGH IMPACT DOUBLE SIDED COUNTER

Available in single sided or double sided, this counter is a great addition to any event. This counter features a fully backlit 1m x 1m display with high-quality white laminate countertop and two white laminate side panels.

CODE	WSLKCO007
ASSEMBLED SIZE	1036 X 1028 X 320mm
VISUAL AREA	1000 X 1000mm
NUMBER OF BAGS	1
PACKED DIMENSIONS	480 x 230 x 1140mm
PACKED WEIGHT	30.5kg
POWER	102W



BRIGHTWALL 130 - COUNTER 3

PREMIUM QUALITY AND FUNCTIONALITY

Our premium backlit display counter features adjustable shelving to the rear of the counter. This counter is available with single sided printed fabric and is made up from a fully backlit 1m x 1m display with a high-quality white laminate countertop and two white laminate side panels. The counter comes complete with 1 white laminate shelf that can be set at three different heights.

Additional shelves can be purchased.

CODE	WSLKC0008
ASSEMBLED SIZE	1036 X 1028 X 320mm
VISUAL AREA	1000 X 1000mm
NUMBER OF BAGS	1
PACKED DIMENSIONS	480 x 230 x 1140mm
PACKED WEIGHT	35kg
POWER	102W



COUNTERS MASTER

Cases

CRO2	RollOne Case
CRP33	RollPlus 33 Case
CRE	RollEase Case
HPZFLEX1314018	Wall System Poly Case - Small
HPZFLEX1315318	Wall System Poly Case - Large
HPZFLEX1316221	Wall System Poly Case - XL
HPZFLEXCASE165	Flexcounter Case

RollOne Counter Conversion

CROPCT	RollOne Premium Countertop
ISGRAPHICROLP	RollOne Case Graphic Panel
CROBSCT	RollOne Black Blotter
CRP33SCT	RollPlus Insert top
CRP33PCT	RollPlus 33 External Counter Top

Free Standing Accessories

CDL014	Screen Kiosk in a Flex Case
CDL013	Shelf Kiosk in a Flex Case
LTRFOLD	Folding Literature Display in a carry Case

COUNTERS

Evolve Counters

Rectangular Single Evolve counter in a Flex Case



Curved Single Evolve counter in a Flex Case



MODCTRRECONE	Rectangular Single Evolve counter in a Flex Case
MODCTRRECEXTRA1	Rectangular Extra module in a Flex Case
MODTRCURONE	Curved Single Evolve counter in a Flex Case
MODTRCUREXTRA1	Curved Extra Module in a Flex Case
MODTRDOORREC	Modular Ctr. Door Panel for Rectangular Module
MODTRDOORCUR	Modular Ctr. Door Panel for Curved Module
MODTR90COR	90° Degree Corner Module in a Flex Case
MODTR90G	90° evolve Module Graphic
MODTRONEG	Single evolve Graphic
MODTRTWOG	Double evolve Graphic

Graphic Counters



REC900/1000

REC900	Graphic Counter with Door in a Flex Case
REC1000	Graphic Counter without Door in a Flex Case
ISGRREC9001000	REC900/1000 Graphic Panel

COUNTERS

Non Backlit Brightwall 130 Counters



WSLKCO003	Counter 1 - 1x1M in soft bag
WSLKCOFAB	Printed Fabric Graphic



WSLKCO004	Counter 2 - 1X1M in polycase
WSLKCOFAB	Printed Fabric Graphic



WSLKCO005	Counter 3 - 1x1M in polycase
WSLKCOFAB	Printed Fabric Graphic

Backlit Brightwall 130 Counters



WSLKCO006	counter 1 - Single Sided
WSLKLBL1X1130BL	Lightblocker
WSLKCOFAB	Printed Fabric Graphic

WSLKCO006	counter 1 - Double Sided
WSLKCOFAB	Printed Fabric Graphic



WSLKCO007	Counter 2 - Single Sided
WSLKLBL1X1130BL	Lightblocker
WSLKCOFAB	Printed Fabric Graphic

WSLKCO007	Counter 2 -Double Sided
WSLKCOFAB	Printed Fabric Graphic



WASSLEKSCO008	Counter 3 - Single sided only
WSLKLBL1X1130BL	Lightblocker
WSLKCOFAB	Printed Fabric Graphic

COUNTERS

BrightCounters

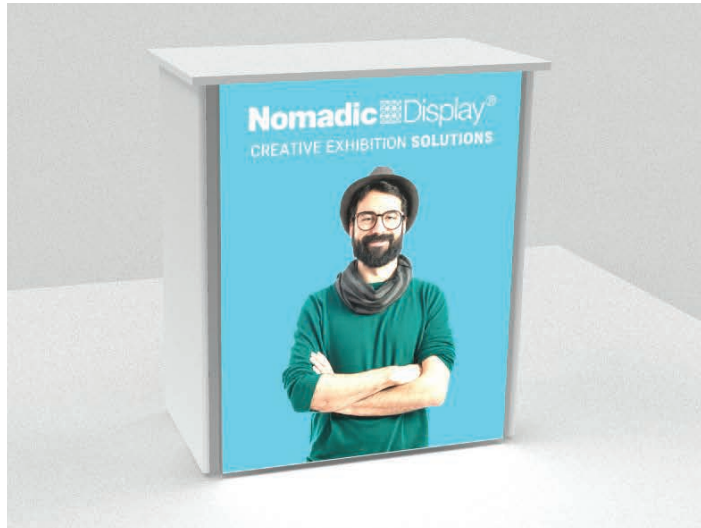

WSLKCO001	Single BrightCounter
WSLKCOLBL	Single Lightblocker
WSLKCOFAB	Single BrightCounter Printed Fabric Graphic
WSLKCO001E	Extra Module for a Double BrightCounter
WSLKCOLBL2	Double Lightblocker
WSLKCOFAB2	Double BrightCounter Printed Fabric Graphic
WSLKCODOOR	Lockable Door
MODCTRRECONE	Rectangular Single Evolve counter in a Flex Case
MODCTRONEG	Single evolve Graphic
FGPRCTRCUR	Promo Counter - Curved (with graphic)
FGPRCTRRND	Promo Counter - Round (with graphic)

NOTES

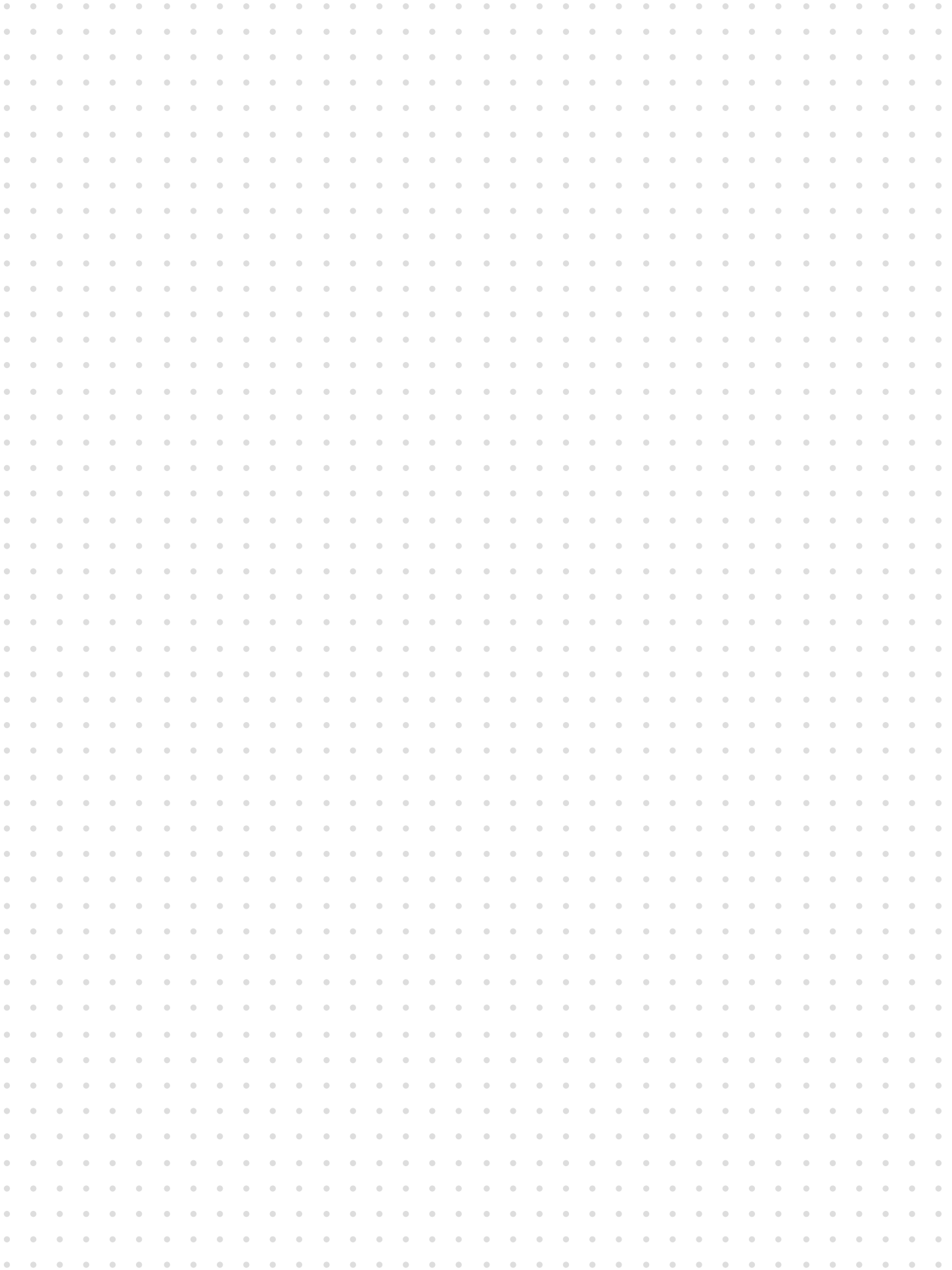

NOTES

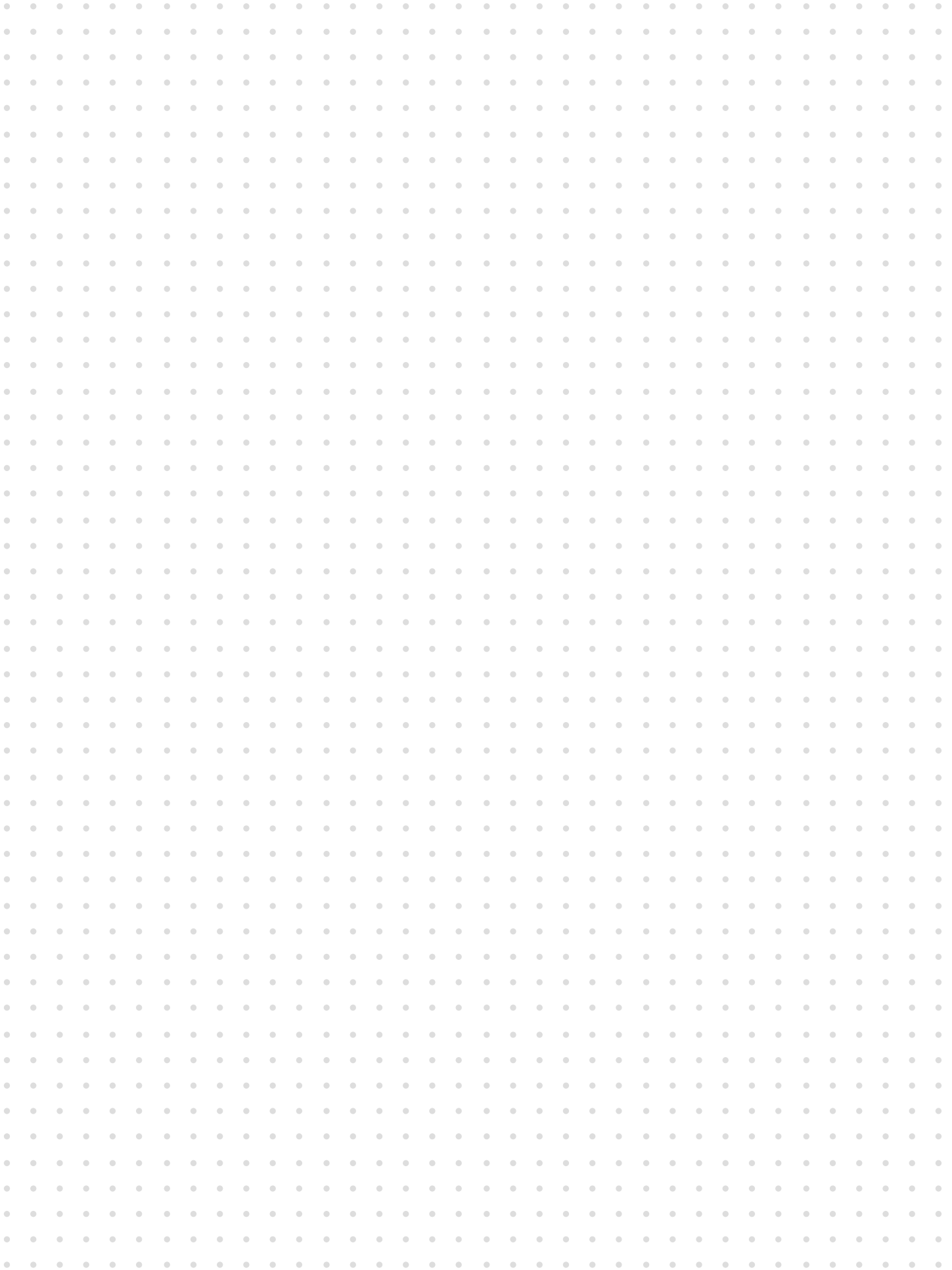



JEROME GANNON
Managing Director

With over 40 years of industry expertise, Nomadic Display stands as a beacon of unmatched craftsmanship, proudly made in Europe. Our legacy is built on delivering exceptional quality and innovative designs that stand the test of time, ensuring your brand makes a memorable impact on the global stage



Caher, Louisburgh,
Co. Mayo, F28P660



+353 98 66011



sales@nomadicdisplay.eu